

Delco Remy Service Parts

Model 1117623

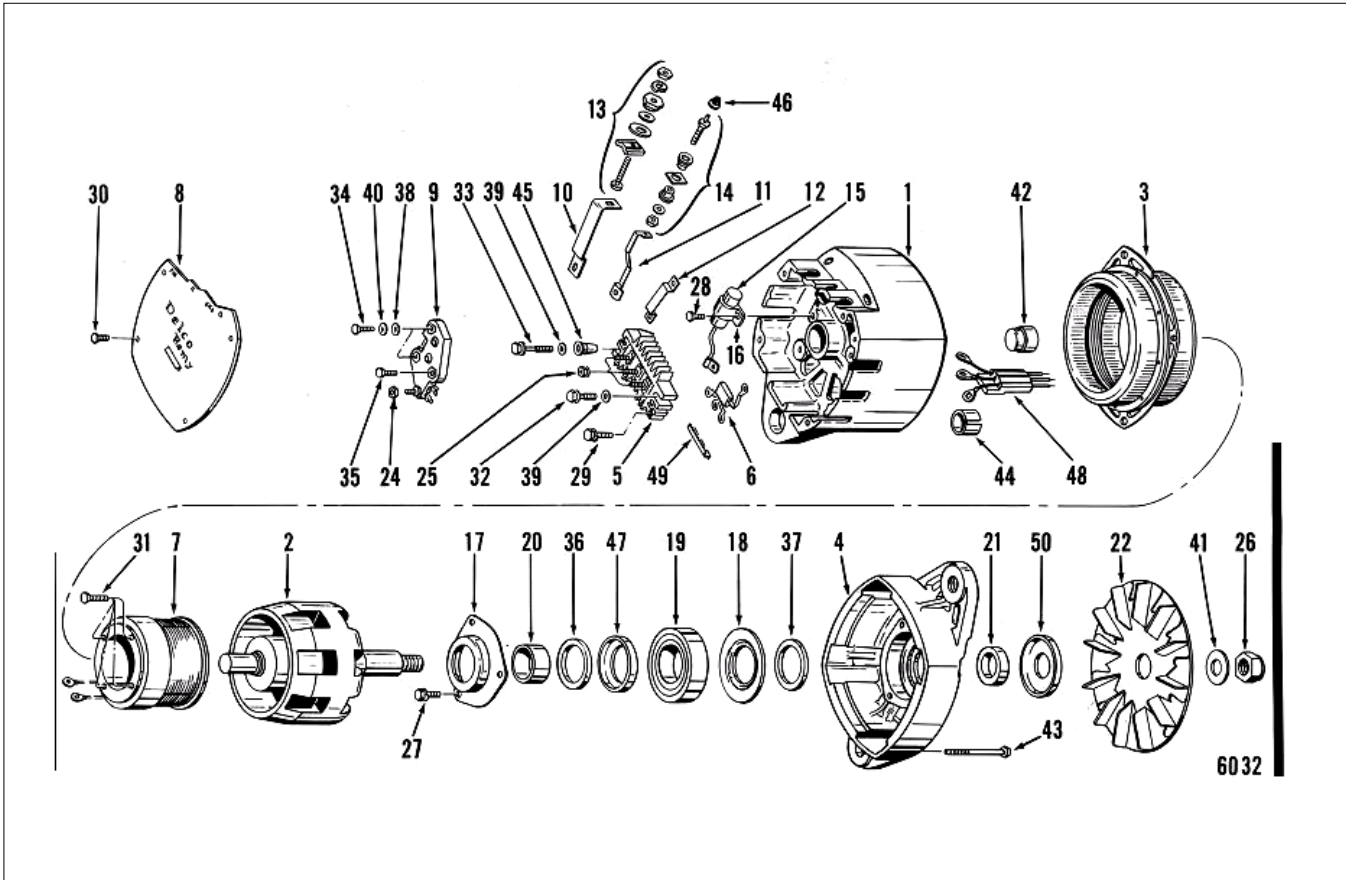

Ref No	Description	Part Number	Notation	Qty Reqd
00	SCREW ASSY	10476069	Rect. Cover Atch. (Internal Tooth LW)	1
01	HOUSING-RECTIFIER	10475809		1
02	ROTOR ASSY	1894446		1
03	STATOR ASSY	1894467		1
04	FRAME-DE	1894483		1
05	RECTIFIER ASSY	1984638		1
06	DIODE TRIO	1987324		1
07	FIELD COIL & SUPPORT	1894474		1
08	COVER	1894444		1
09	REGULATOR	1116405	Service by Complete Replacement	1
10	CONNECTOR	1894464	Output Term.	1
11	CONNECTOR	1894473	Relay Term.	1
12	CONNECTOR	1894462	Rect. Bridge to Regulator	1
13	OUTPUT TERMINAL	1894626		1
14	RELAY TERMINAL	1894627		1
15	CAPACITOR	1985444		1
17	RETAINER PLATE	1961867	Inside DE	1
18	PLATE-RETAINER	1955664	Outside DE	1
19	BALL BEARING ASSY	9437824		1
20	COLLAR	1957726	Inside - Bearing Space - DE	1
22	FAN	10467272	Fan & Baffle Asm.	1
24	NUT-LOCK	830288	Rect. Bridge to Regulator	1
25	NUT-LOCK	830288	Rect. Bridge Atch.	3

Delco Remy Service Parts

Model 1117623

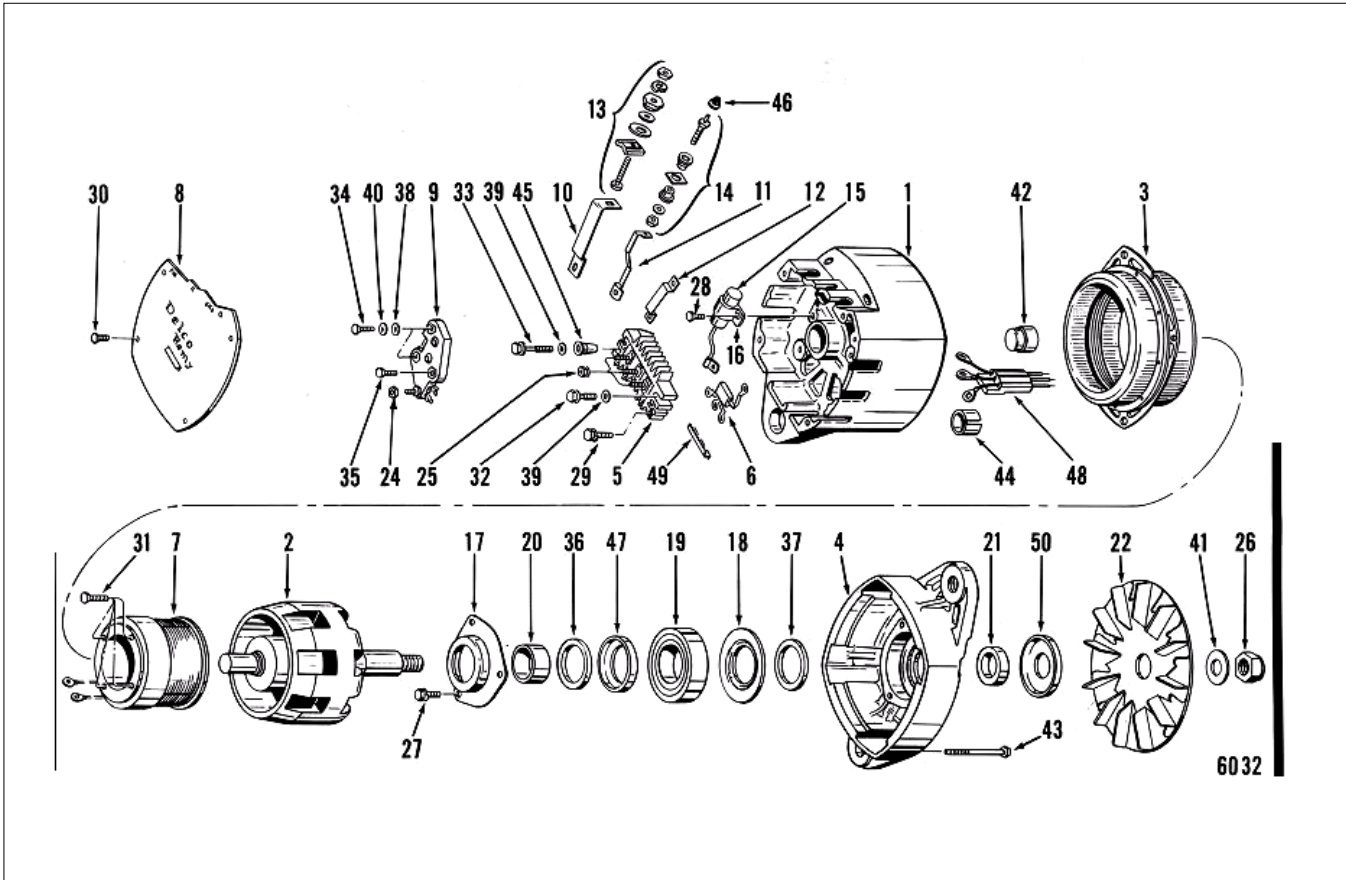

Ref No	Description	Part Number	Notation	Qty Reqd
26	NUT-SHAFT-D.E.	10484823		1
27	SCREW ASSY	1846956	Bearing Retainer Atch. - DE	3
28	SCREW ASSY	1846955	Capacitor Atch.	1
29	SCREW ASSY	1846955	Connector - Bridge to Reg. Atch.	1
30	SCREW ASSY	1894641	Rect. Cover Atch.	4
31	SCREW	1968945	Field Coil & Support Atch.	4
32	SCREW ASSY	1894458	Regulator Atch. (Ground.)	1
33	SCREW ASSY	830338	Rect. Bridge Atch. (1 11/32")	1
34	SCREW ASSY	1976061	Regulator Atch. (Insul.)	2
35	SCREW ASSY	1894458	Rect. Bridge Atch. (1 11/16")	1
37	WASHER-INSULATION	1955660	Felt - Ball Bearing - DE	1
39	WASHER-RECT. BRIDGE ATTACH. SCREW	807295	Rect. Bridge Term. Stud	2
41	WASHER-SHAFT-D.E.	10484823		1
42	ROLLER BEARING	9437171	Rect. Housing	1
43	THRU BOLT	1894445		4
44	BUSHING	1892765	Hinge - Rect. Housing	1
45	BUSHING	1894463	Rect. Bridge Atch. - Insul.	1
46	CAP	1970227	Relay Term.	1
48	GROMMET	1894468		1