

Delco Remy Service Parts

Model 1117733

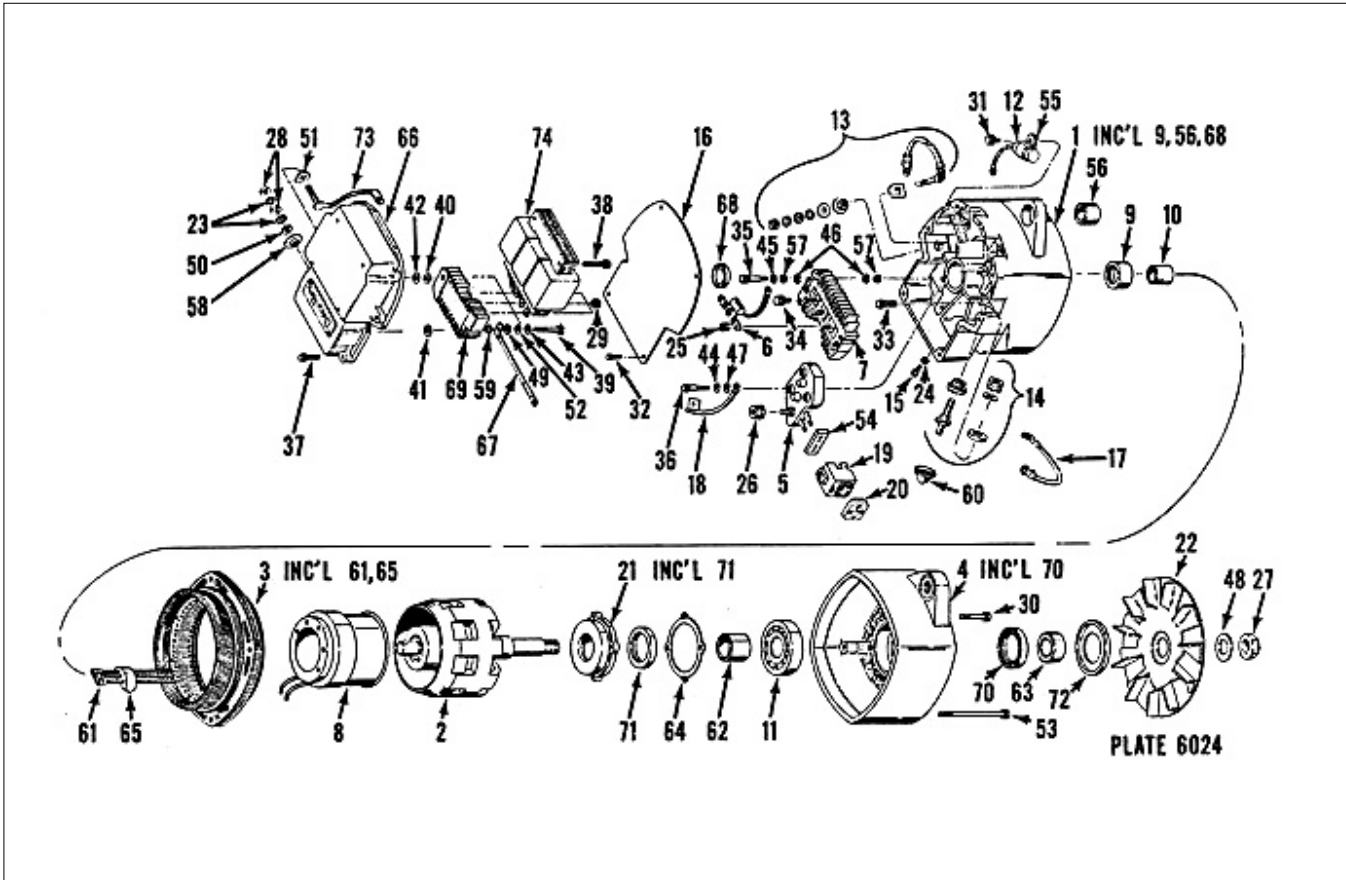

Ref No	Description	Part Number	Notation	Qty Reqd
00	INSULATION	830489		
01	HOUSING-RECTIFIER	1876760		
02	ROTOR ASSY	1968904		
03	STATOR ASSY	1876769		
04	FRAME-DE	1852726		
05	REGULATOR	1987518	SERVICE BY COMPLETE REPLACEMENT.	
06	DIODE TRIO	1876797		
07	RECTIFIER BRIDGE ASSY	1880132		
08	FIELD COIL & SUPPORT ASSY	1876768		
09	ROLLER BEARING	9436064		
10	RACE-ROLLER BEARING	9436063		
11	BALL BEARING ASSY	10472935		
12	CAPACITOR ASSY	1880046		
13	TERM. PACKAGE/OUTPUT	-	POSITIVE USES 1876897 OUTPUT TERM.	
16	PLATE-COVER	1876814		
18	LEAD/BRIDGE TO REG.	1876807		
19	BODY-CONNECTOR	1876772		
20	CAP	801532		
21	RETAINER/D.E. BEARING	10497221		
22	FAN	1969481		
25	NUT ASSY	1851808		
26	NUT ASSY	1851808		
27	NUT-ROTOR SHAFT-D.E.	10484823		

NEGATIVE USES 1049656

Delco Remy Service Parts

Model 1117733

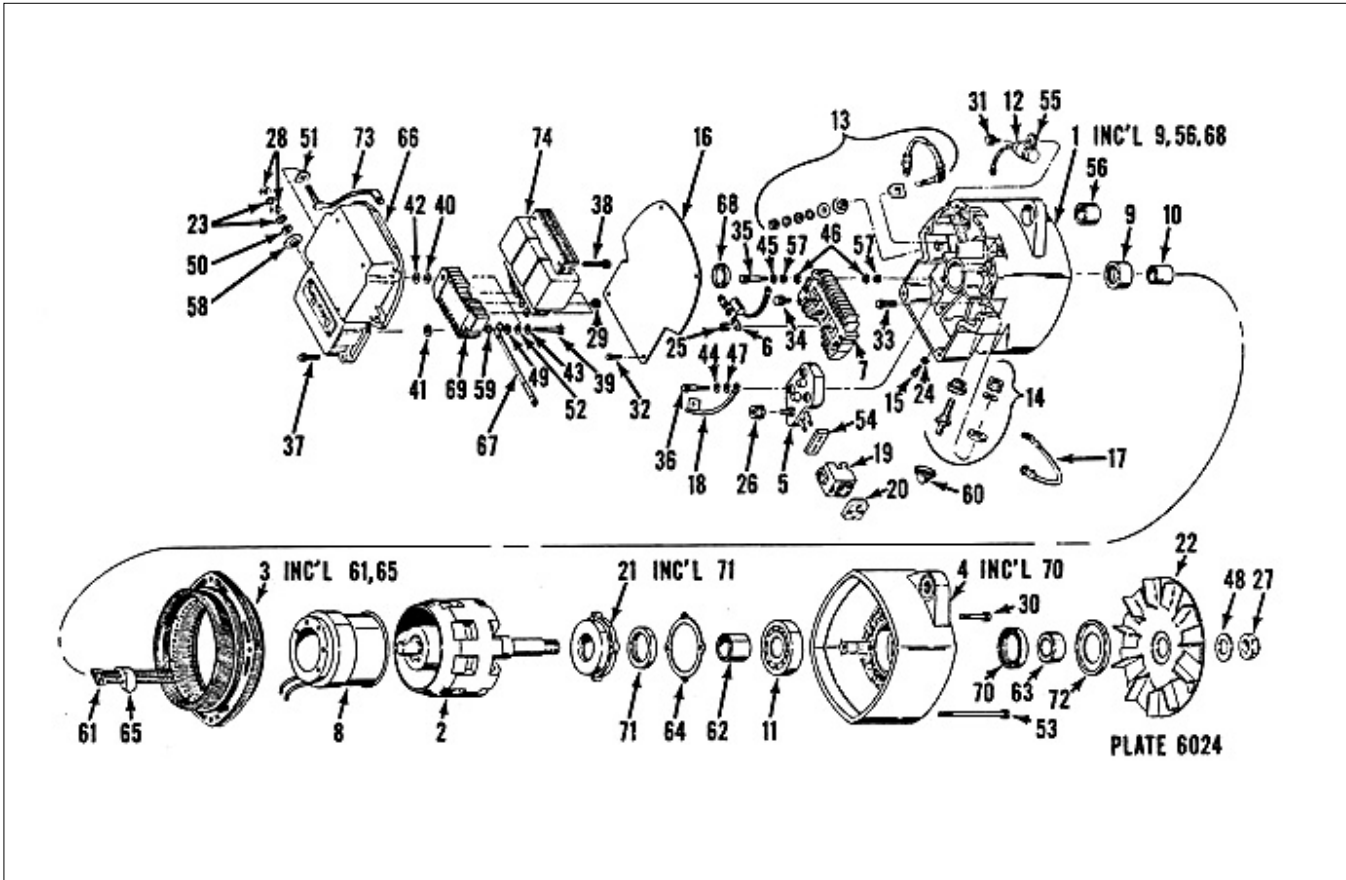

Ref No	Description	Part Number	Notation	Qty Reqd
30	SCREW ASSY	10497222		
31	SCREW ASSY	1846955		
32	SCREW ASSY	1846955		
33	SCREW	1968945		
34	SCREW ASSY	1846955		
35	SCREW ASSY	830335		
36	SCREW ASSY	1976061		
44	WASHER-INSUL.-REG. ATTACH. SCREW	1913846		
45	WASHER-PLAIN (.20" I.D.)-RECT. BRID	807295		
45	WASHER	1919478		
46	WASHER	1919478		
47	WASHER-PLAIN-REGULATOR ATTACH. SCRE	807295		
48	WASHER-SHAFT NUT	10484823		
53	THRU BOLT	1968991		
54	BOOT	1876806		
55	BRACKET-CAPACITOR	1880118		
56	BUSHING	1892765		
57	BUSHING	1966879		
61	CLIP-TERM.-STATOR LEADS	1969671		
62	COLLAR (INSIDE)-SPACE-D.E. BEARING	10497218		
63	COLLAR (OUTSIDE)-SPACE-D.E.	-	IF AN OUTSIDE BEARING SEAL (ILLUS. 70) IS USED-	1968890 COLLAR M
64	GASKET	1968884		
65	GROMMET	1876805		

Delco Remy Service Parts
Model 1117733

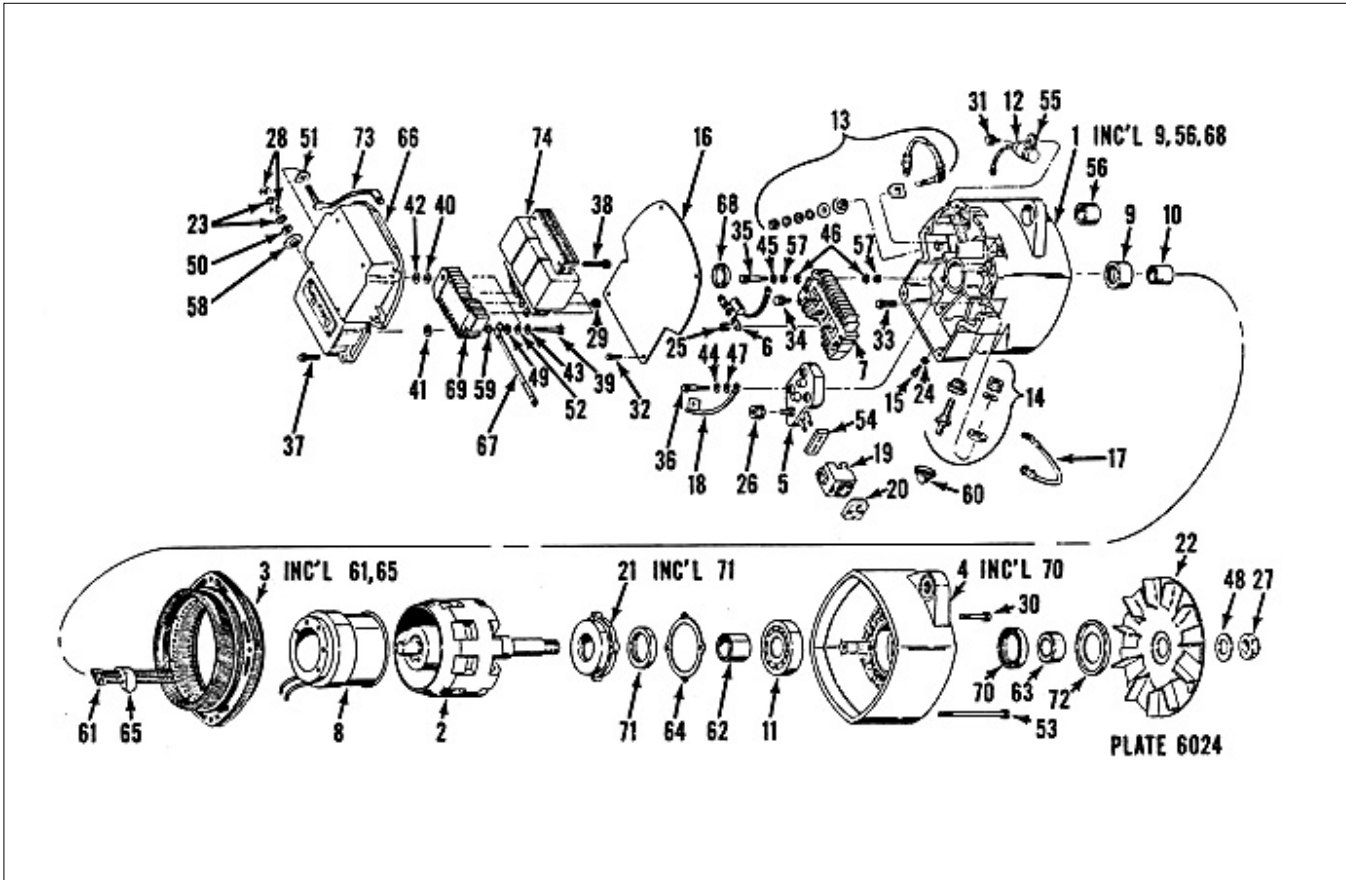

Ref No	Description	Part Number	Notation	Qty Reqd
68	PLUG-BEARING WELL	1876813		
70	SEAL-OIL	1958509		
71	SEAL-OIL	1958509		
72	SLINGER-GREASE-D.E.	10492163	1968891 SLINGER NOT REQUIRED WITH ALUMINUM FAN	