

Delco Remy Service Parts

Model 1990377

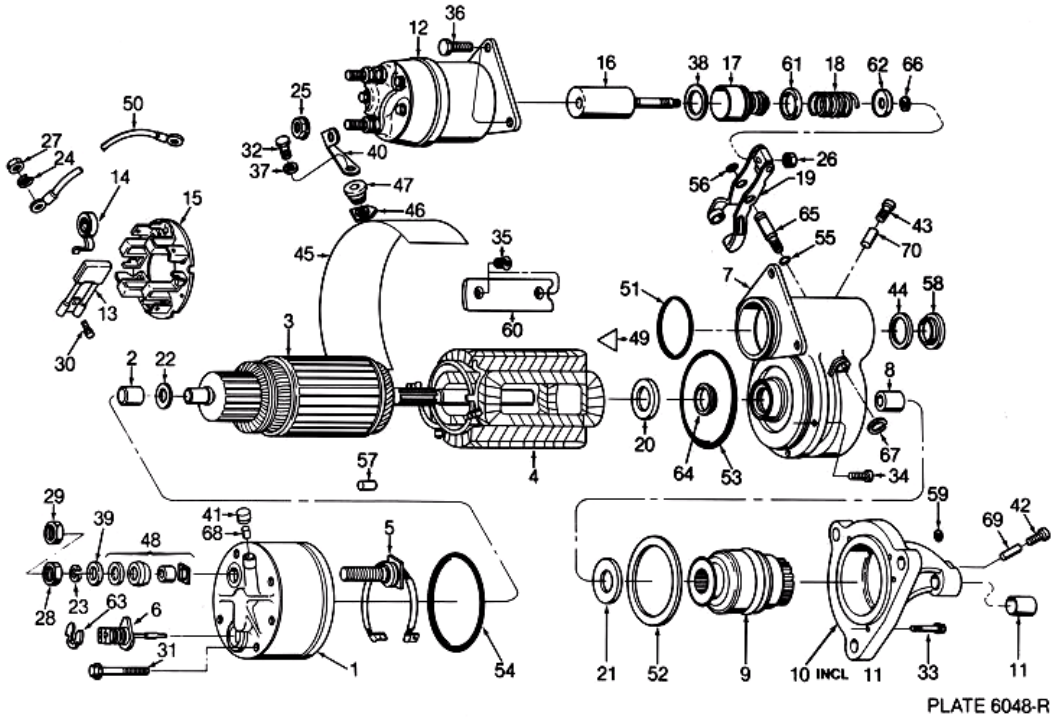

Ref No	Description	Part Number	Notation	Qty Reqd
01	CE HOUSING ASSY	1988126		
01	CE HOUSING ASSY	1988126		
02	BUSHING	1943628	USED IN SERVICE PACKAGE B	
02	BUSHING	1943628	USED IN SERVICE PACKAGE B	
03	ARMATURE ASSY	1987989		
03	ARMATURE ASSY	1987989		
04	FIELD COIL ASSY	1988111		
04	FIELD COIL ASSY	1988111		
05	TERMINAL & LEAD ASSY	1988128		
05	TERMINAL & LEAD ASSY	1988128		
07	LEVER HOUSING ASSY	1988436		
07	LEVER HOUSING ASSY	1988436		
08	BUSHING	1988096	USED IN SERVICE PACKAGE B	
08	BUSHING	1988096	USED IN SERVICE PACKAGE B	
09	DRIVE ASSY	1893562	SERVICE BY COMPLETE REPLACEMENT.	
09	DRIVE ASSY	1893562	SERVICE BY COMPLETE REPLACEMENT.	
10	HOUSING-NOSE	1988137		
10	HOUSING-NOSE	1988137		
11	BUSHING	1894635	USED IN SERVICE PACKAGE B	
11	BUSHING	1894635	USED IN SERVICE PACKAGE B	
12	SOLENOID	1115593	FOR PARTS SEE SOLENOID PART NUMBER	
12	SOLENOID	1115593	FOR PARTS SEE SOLENOID PART NUMBER	
13	BRUSH	1852892	USED IN SERVICE PACKAGE A	

Delco Remy Service Parts

Model 1990377

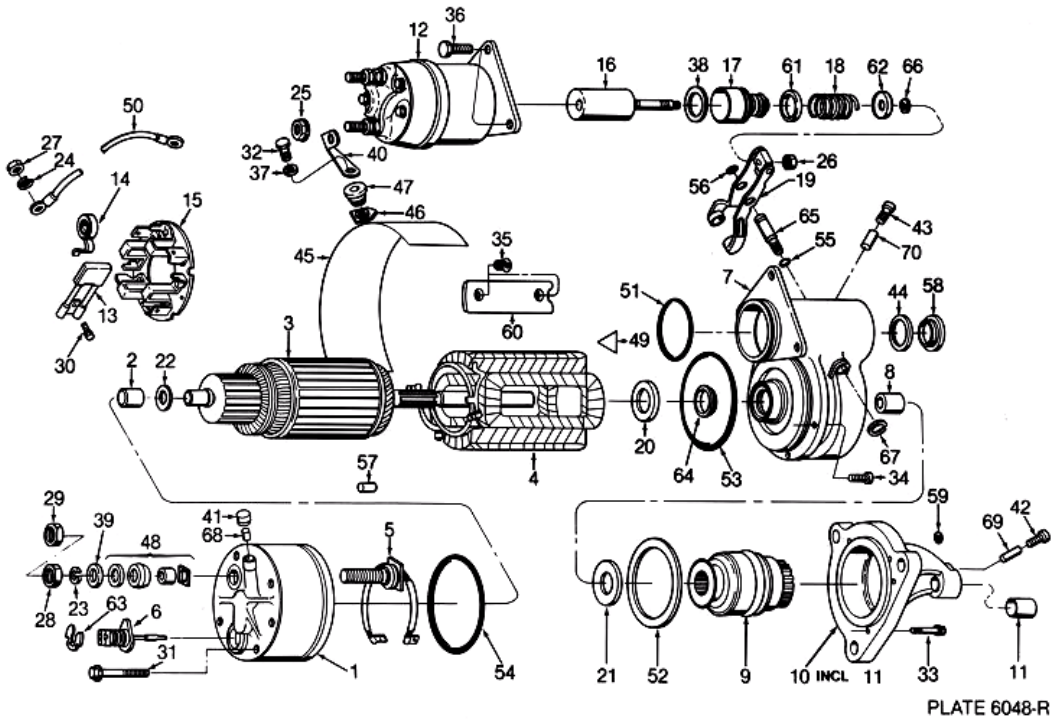

Ref No	Description	Part Number	Notation	Qty Reqd
13	BRUSH	1852892	USED IN SERVICE PACKAGE A	
14	SPRING-BRUSH	1985314	USED IN SERVICE PACKAGE A	
14	SPRING-BRUSH	1985314	USED IN SERVICE PACKAGE A	
15	BRUSH PLATE ASSY	1988121		
15	BRUSH PLATE ASSY	1988121		
16	PLUNGER ASSY	1988140		
16	PLUNGER ASSY	1988140		
17	BOOT ASSY	1985243		
17	BOOT ASSY	1985243		
18	SPRING	1948521		
18	SPRING	1948521		
19	SHIFT LEVER ASSY	1988097	USED IN SERVICE PACKAGE C	
19	SHIFT LEVER ASSY	1988097	USED IN SERVICE PACKAGE C	
20	SPACER	1936466	USED IN SERVICE PACKAGE B	
20	SPACER	1936466	USED IN SERVICE PACKAGE B	
21	WASHER	1911644	USED IN SERVICE PACKAGE B	
21	WASHER	1911644	USED IN SERVICE PACKAGE B	
22	WASHER	1985617	USED IN SERVICE PACKAGE B	
22	WASHER	1985617	USED IN SERVICE PACKAGE B	
23	LOCK WASHER-TERMINAL STUD-C.E.	9421427		
23	LOCK WASHER-TERM. STUD-C.E.	9421427		
24	LOCK WASHER-SHUNT LEAD TO SWITCH AT	453435		
24	LOCK WASHER-SHUNT LEAD TO SWITCH AT	453435		

Delco Remy Service Parts

Model 1990377

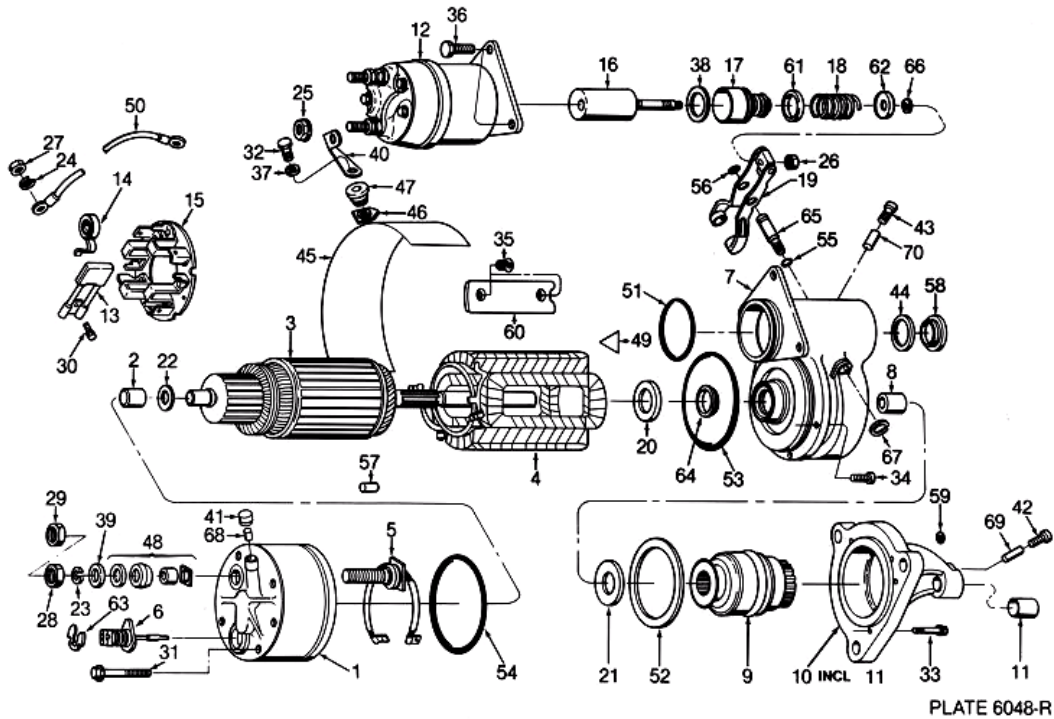

Ref No	Description	Part Number	Notation	Qty Reqd
25	NUT	1979451		
25	NUT	1979451		
26	NUT	9412305	USED IN SERVICE PACKAGE B & C	
26	NUT	9412305	USED IN SERVICE PACKAGE B & C	
27	NUT ASSY	1979365		
27	NUT ASSY	1979365		
28	NUT-TERM.-C.E. FRAME	9441934		
28	NUT-TERMINAL-C.E. FRAME	9441934		
29	NUT	1979451		
29	NUT	1979451		
30	SCREW	10467191	USED IN SERVICE PACKAGE A	
30	SCREW	10467191	USED IN SERVICE PACKAGE A	
31	SCREW ASSY	10499635	USED IN SERVICE PACKAGE A & B	
31	SCREW ASSY	10499635	USED IN SERVICE PACKAGE A & B	
32	BOLT	10497770		
32	BOLT	10497770		
33	SCREW	10499643		
33	SCREW	10499643		
34	BOLT	1914869		
34	BOLT	1914869		
35	SCREW	10499632		
35	SCREW	10499632		
36	BOLT	10497770		

Delco Remy Service Parts

Model 1990377

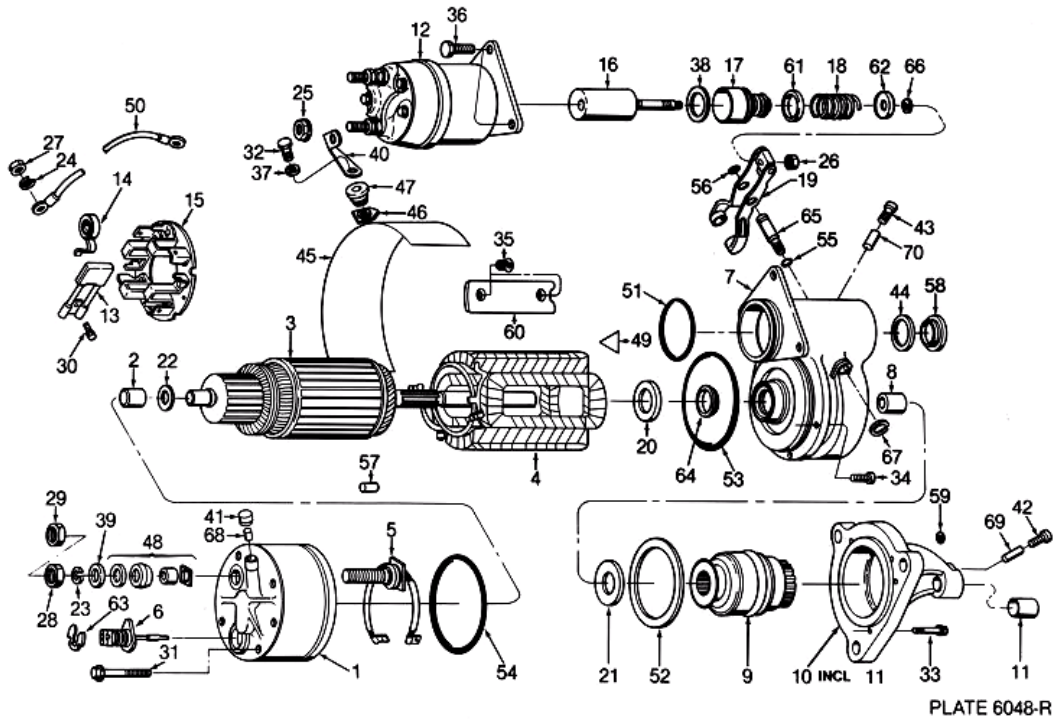

Ref No	Description	Part Number	Notation	Qty Reqd
36	BOLT	10497770		
37	WASHER	1905125		
37	WASHER	1905125		
38	WASHER	1948519		
38	WASHER	1948519		
39	WASHER	30205		
39	WASHER	30205		
40	CONNECTOR	10476198		
40	CONNECTOR	10476198		
41	CUP	1985246	USED IN SERVICE PACKAGE B	
41	CUP	1985246	USED IN SERVICE PACKAGE B	
42	CUP	1978756	USED IN SERVICE PACKAGE B	
42	CUP	1978756	USED IN SERVICE PACKAGE B	
43	CUP	1985246	USED IN SERVICE PACKAGE B	
43	CUP	1985246	USED IN SERVICE PACKAGE B	
44	GASKET	1964857	USED IN SERVICE PACKAGE B & C	
44	GASKET	1964857	USED IN SERVICE PACKAGE B & C	
45	INSULATOR	1988100		
45	INSULATOR	1988100		
46	INSULATOR-TERMINAL	1988339		
46	INSULATOR-TERMINAL	1988339		
47	INSULATOR-TERMINAL	1988340		
47	INSULATOR-TERMINAL	1988340		

Delco Remy Service Parts

Model 1990377

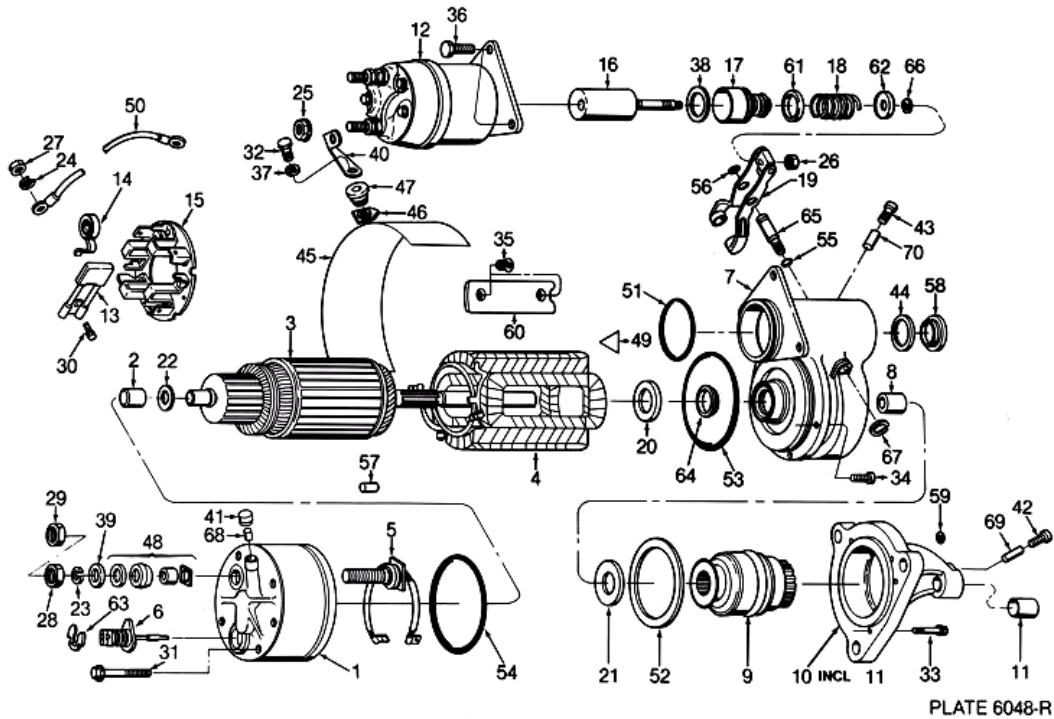

Ref No	Description	Part Number	Notation	Qty Reqd
48	SERV PKG	10495183		
48	SERV PKG	10495183		
50	LEAD ASSY	10497105		
50	LEAD ASSY	10497105		
51	O RING	1985304	USED IN SERVICE PACKAGE B & C	
51	O RING	1985304	USED IN SERVICE PACKAGE B & C	
52	O RING	1851960	USED IN SERVICE PACKAGE B & C	
52	O RING	1851960	USED IN SERVICE PACKAGE B & C	
53	O RING	1916272	USED IN SERVICE PACKAGE B	
53	O RING	1916272	USED IN SERVICE PACKAGE B	
54	O RING	1985320	USED IN SERVICE PACKAGE A & B	
54	O RING	1985320	USED IN SERVICE PACKAGE A & B	
55	O RING	1894642	USED IN SERVICE PACKAGE C	
55	O RING	1894642	USED IN SERVICE PACKAGE C	
56	O RING	1894643	USED IN SERVICE PACKAGE C	
56	O RING	1894643	USED IN SERVICE PACKAGE C	
57	PIN-SPRING	456652		
57	PIN-SPRING	456652		
58	PLUG	1945356		
58	PLUG	1945356		
60	SHOE-POLE	1934478		
60	SHOE-POLE	1934478		
61	RETAINER-SPRING	1948520		

Delco Remy Service Parts

Model 1990377

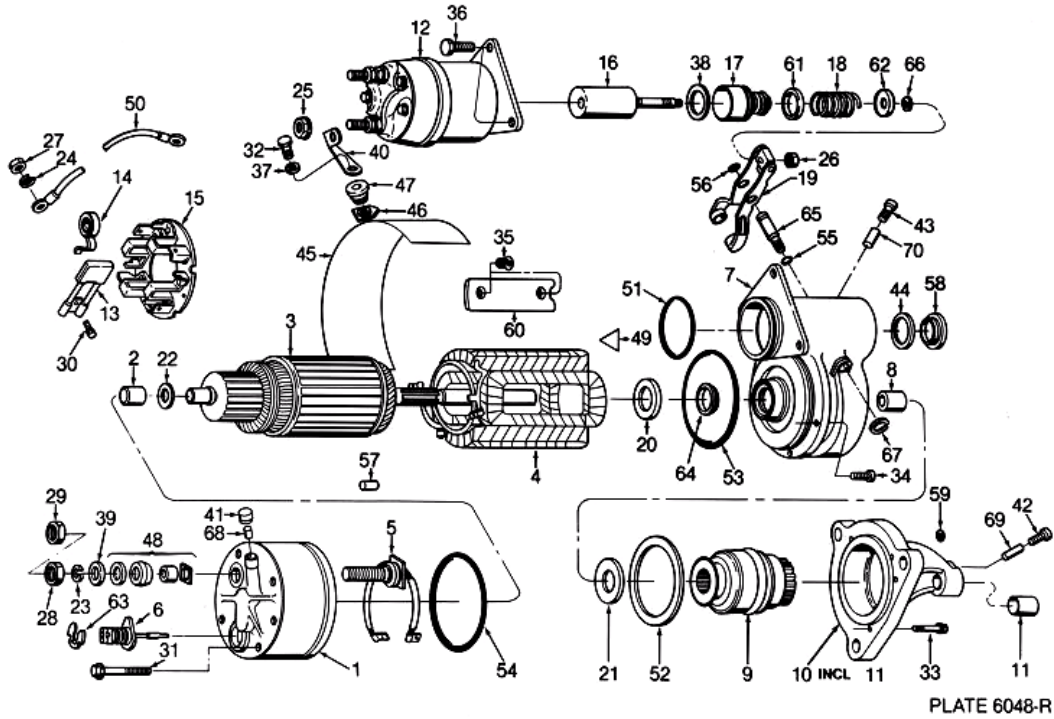

Ref No	Description	Part Number	Notation	Qty Reqd
61	RETAINER-SPRING	1948520		
62	RETAINER-SPRING	1948526		
62	RETAINER-SPRING	1948526		
64	SEAL-OIL	1918047	USED IN SERVICE PACKAGE B	
64	SEAL-OIL	1918047	USED IN SERVICE PACKAGE B	
65	SHAFT-LEVER	1948529	USED IN SERVICE PACKAGE C	
65	SHAFT-LEVER	1948529	USED IN SERVICE PACKAGE C	
66	RING	9416374		
66	RING	9416374		
67	RING	9416374	USED IN SERVICE PACKAGE C	
67	RING	9416374	USED IN SERVICE PACKAGE C	
68	WICK	1985247	USED IN SERVICE PACKAGE B	
68	WICK	1985247	USED IN SERVICE PACKAGE B	
69	WICK	1978754	USED IN SERVICE PACKAGE B	
69	WICK	1978754	USED IN SERVICE PACKAGE B	
70	WICK	1985247	USED IN SERVICE PACKAGE B	
70	WICK	1985247	USED IN SERVICE PACKAGE B	
A	SERV PKG, BRUSH	1989495		0
B	SERV PKG, BRUSHING	1989497		0
C	SERV PKG, SHIFT LEVER	1989498		0