

# Delco Remy Service Parts

Model 1990483

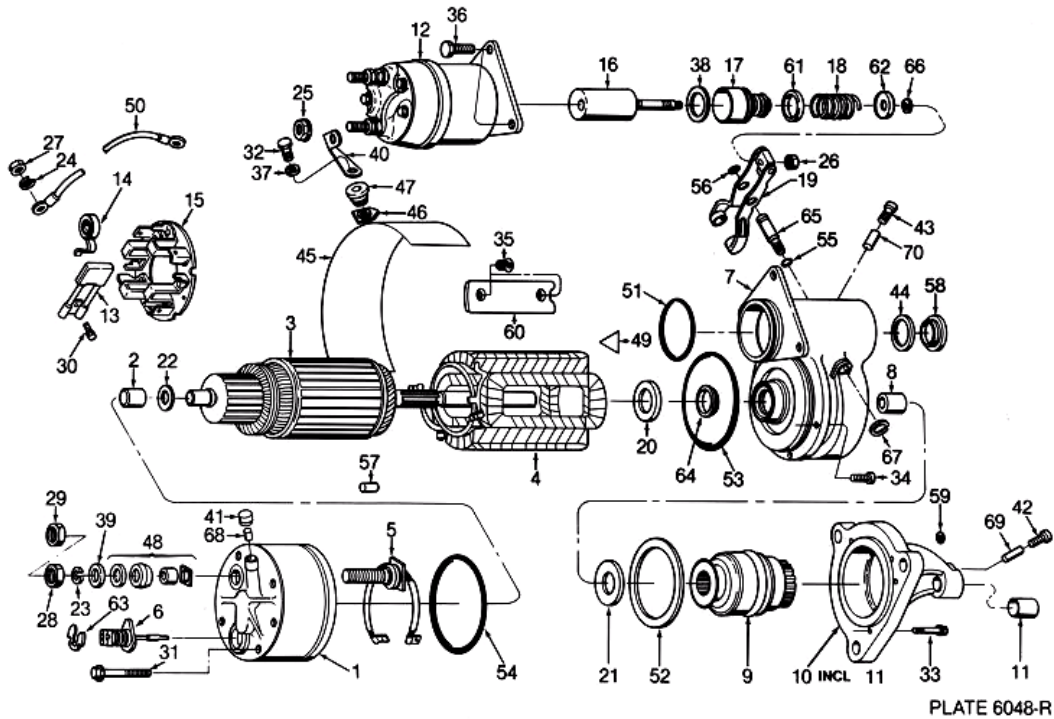

Ref No	Description	Part Number	Notation	Qty Reqd
01	CE HOUSING ASSY	1988126		
02	BUSHING	1943628	USED IN SERVICE PACKAGE B	
03	ARMATURE ASSY	1987989		
04	FIELD COIL ASSY	1988111		
05	TERMINAL & LEAD ASSY	1988128		
07	LEVER HOUSING ASSY	1988436		
08	BUSHING	1988096	USED IN SERVICE PACKAGE B	
09	DRIVE ASSY	830620	SERVICE BY COMPLETE REPLACEMENT.	
10	HOUSING-NOSE	1988137		
11	BUSHING	1894635	USED IN SERVICE PACKAGE B	
12	SOLENOID	1115593	FOR PARTS SEE SOLENOID PART NUMBER	
13	BRUSH	1852892	USED IN SERVICE PACKAGE A	
14	SPRING-BRUSH	1985314	USED IN SERVICE PACKAGE A	
15	BRUSH PLATE ASSY	1988121		
16	PLUNGER ASSY	1988140		
17	BOOT ASSY	1988776		
18	SPRING	1948521		
19	SHIFT LEVER ASSY	1988097	USED IN SERVICE PACKAGE C	
20	SPACER	1936466	USED IN SERVICE PACKAGE B	
21	WASHER	1911644	USED IN SERVICE PACKAGE B	
22	WASHER	1985617	USED IN SERVICE PACKAGE B	
23	LOCK WASHER-TERM. STUD-C.E.	9421427		
25	NUT	1979451		

# Delco Remy Service Parts

Model 1990483

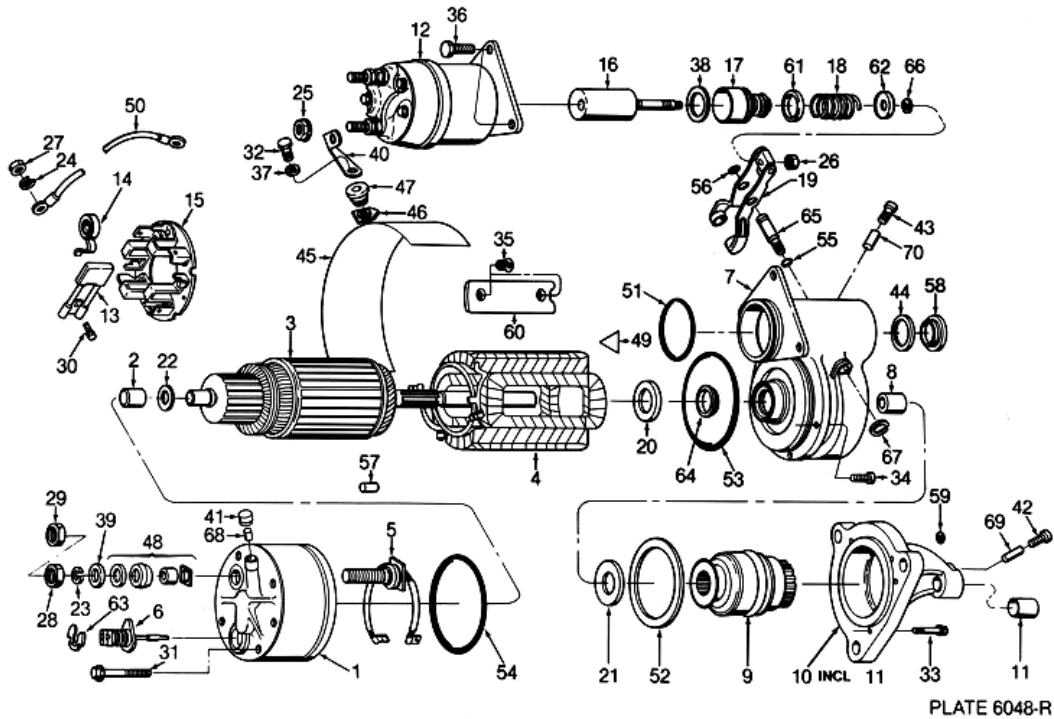

Ref No	Description	Part Number	Notation	Qty Reqd
26	NUT	9412305	USED IN SERVICE PACKAGE B & C	
27	NUT ASSY	1979365		
28	NUT-TERM.-C.E. FRAME	9441934		
29	NUT	1979451		
30	SCREW	10467191	USED IN SERVICE PACKAGE A	
31	SCREW ASSY	10499635	USED IN SERVICE PACKAGE A & B	
32	BOLT	10497770		
33	SCREW	1948537		
34	BOLT	1914869		
35	SCREW	10499632		
36	BOLT	10497770		
37	WASHER	1905125		
38	WASHER	1948519		
39	WASHER	1914647		
40	CONNECTOR	10476198		
41	CUP	1985246	USED IN SERVICE PACKAGE B	
42	CUP	1978756	USED IN SERVICE PACKAGE B	
43	CUP	1985246	USED IN SERVICE PACKAGE B	
44	GASKET	1964857	USED IN SERVICE PACKAGE B & C	
45	INSULATOR	1988100		
46	INSULATOR-TERMINAL	1988339		
47	INSULATOR-TERMINAL	1988340		
48	SERV PKG	10495183		

# Delco Remy Service Parts

Model 1990483

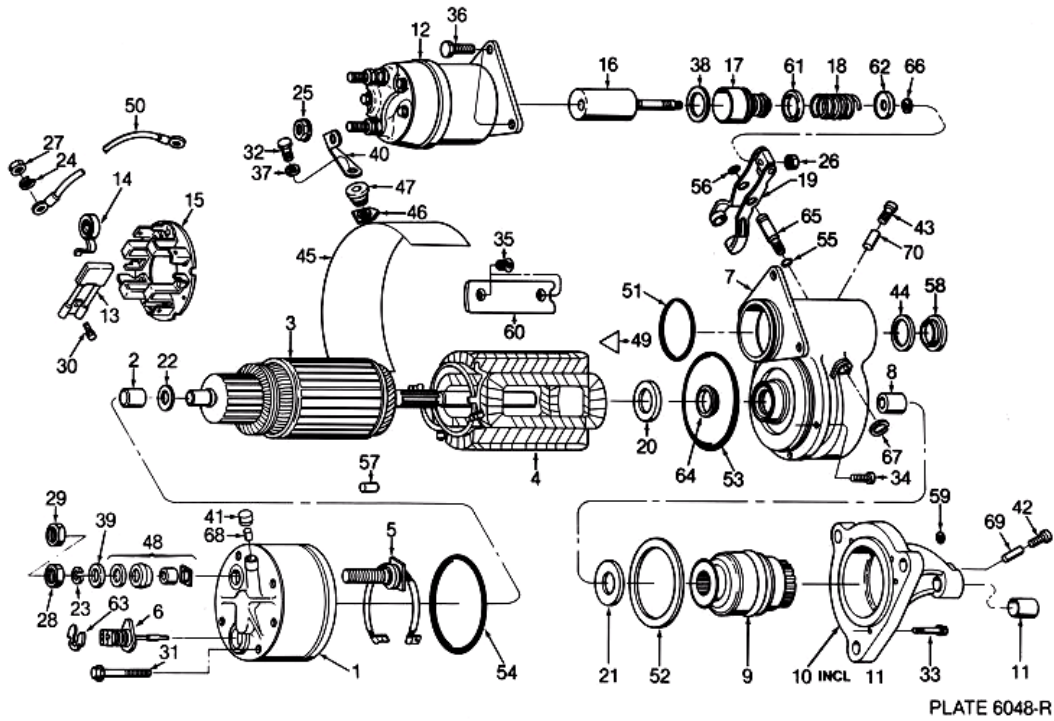

Ref No	Description	Part Number	Notation	Qty Reqd
50	LEAD ASSY	10497105		
51	O RING	1985304	USED IN SERVICE PACKAGE B & C	
52	O RING	1851960	USED IN SERVICE PACKAGE B & C	
53	O RING	1916272	USED IN SERVICE PACKAGE B	
54	O RING	1985320	USED IN SERVICE PACKAGE A & B	
55	O RING	1894642	USED IN SERVICE PACKAGE C	
56	O RING	1894643	USED IN SERVICE PACKAGE C	
57	PIN-SPRING	456652		
58	PLUG	1945356		
59	PLUG	1949619		
60	SHOE-POLE	1934478		
61	RETAINER-SPRING	1948520		
62	RETAINER-SPRING	1948526		
64	SEAL-OIL	1918047	USED IN SERVICE PACKAGE B	
65	SHAFT-LEVER	1948529	USED IN SERVICE PACKAGE C	
66	RING	9416374		
67	RING	9416374	USED IN SERVICE PACKAGE C	
68	WICK	1985247	USED IN SERVICE PACKAGE B	
69	WICK	1978754	USED IN SERVICE PACKAGE B	
70	WICK	1985247	USED IN SERVICE PACKAGE B	
A	SERV PKG, BRUSH	1989495		0
B	SERV PKG, BUSHING	1989497		0
C	SERV PKG, SHIFT LEVER	1989498		0